

MPT-250B WIRE CRIMP PULL TESTER



STANDARD FEATURES

- Capacity: 250 lb, 1112 N, 113 Kg
- Display units in pounds, newtons or kilograms (dip switch controlled)
- Resolution: 0.1 lb
- Accuracy: \pm (0.5 % Reading + 1 Least Significant Digit)
- Digital Display with Peak Hold
- Backlit LCD Display with 0.56" High Digits
- 1" - 10" Per minute Selectable Rate of Pull in ten 1"/min increments \pm 1/8"/min @ 1" - 5"/min
 \pm 1/4"/min @ 6" - 10"/min
- Auto Stop on Wire Break
- Calibration Self-Test each time unit is switched ON (enabled or disabled by dip switch)
- Auto Return to Start Position in Reset Mode
- Factory Set Overload Protection
- Versatile 15-Position Slotted Terminal Lower Grip (P/N 15-3087)
- Self-Tightening Cam-Type Upper Grip (P/N 15-3040)
- Easy Setup, Operation and Grip Change
- Compact Size
- AC Line Filter
- 115 VAC 50/60Hz Power with .3 Amp Fuse
- Adjustable Front Feet for Optimum Test Position

OPTIONAL FEATURES

- Adjustable Load Set Point for Motor Stop (optional - P/N 15-1547)
- Constant Force Mode - per UL 486A (optional - P/N 15-7007)
- 230 VAC 50/60 Hz Power (built in)

OPTIONAL ACCESSORIES

- Self-Tightening Cam-Type Lower Grip (P/N 15-3202)
- Heavy-Duty Swivel Lockdown Upper Grip (P/N 15-3032 and 15-0080)
- Ring Terminal Lower Grip (P/N 15-0066)
- Custom Grips

PHYSICAL

- Weight 25 Lbs (less options)
- Shipping Weight 31 Lbs (with standard grips)
- Base Dimensions: H. 15.5", W. 10", D. 16"

CALIBRATION

- New units supplied with certificate of calibration traceable to NIST
- Factory calibration available
- In order to maintain NIST traceability, Do Not Exceed 12 Months Between Calibrations

MPT-250B-SC

- Fitted for testing Safe-T-Cable® Assemblies

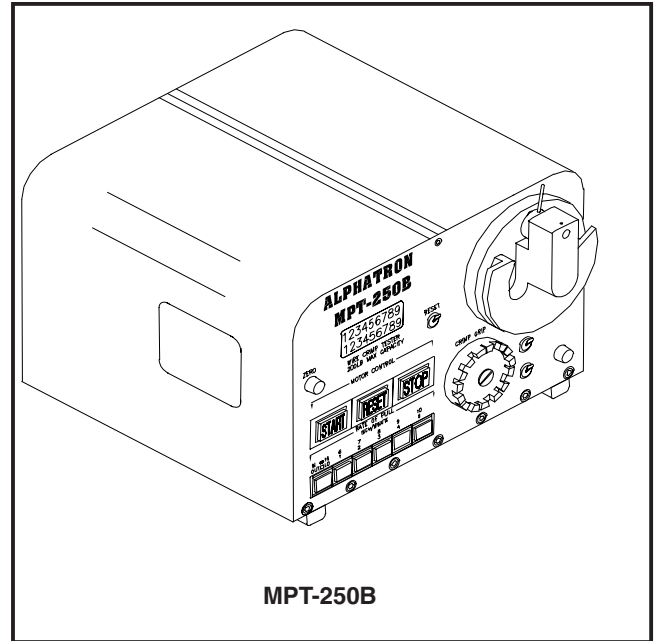

MPT-250B

STANDARD GRIPS

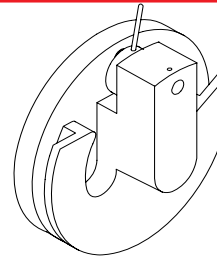

15-3040

Self-Tightening (Upper)

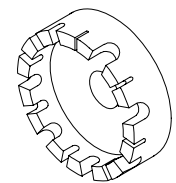

15-3087

Slotted Terminal (Lower)

SLOT DIMENSION			
1	.031"	9	.094"
2	.250"	10	.188"
3	.047"	11	.110"
4	.236"	12	.172"
5	.063"	13	.125"
6	.218"	14	.158"
7	.080"	15	.141"
8	.203"		

OPTIONAL LOWER GRIPS

Self-Tightening
(Lower)

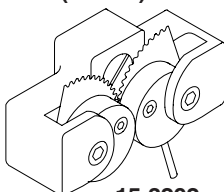

15-3202

Ring Terminal

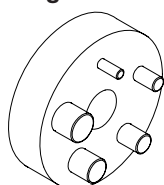

15-0066

Minature Terminal
Grip

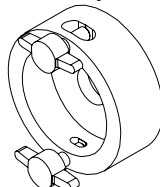

15-3241

OPTIONAL UPPER GRIPS

Threaded Upper Grip

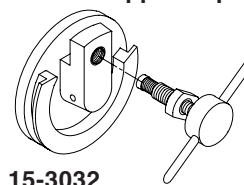

15-3032

15-0080

Short Wire Grip

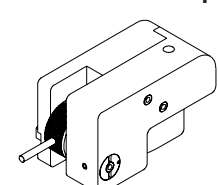

15-0070

DANIELS MANUFACTURING CORP., 526 THORPE ROAD, ORLANDO, FL 32824, USA

PHONE (407) 855-6161 • FAX (407) 855-6884 • WWW.DMCTOOLS.COM • E-MAIL: DMC@DMCTOOLS.COM